

Type 304 Y-Check Valve

Standard Features

- **Size**
1/2"–3"
- **Material**
Transparent PVC
- **Connection Ends**
ASTM Spigot
- **Seals**
EPDM or FPM
- **Mounting Angle**
Horizontal or vertical



General

The Y-Check valve Type 304 is a weighted angle check valve and is used to automatically stop flow in the back direction when the fluid in the line reverses. The valve closes by the dead weight of the weighted seat and functions when mounted in either the horizontal or vertical plane. Y-Check valve Type 304 is superior to spring loaded checks for corrosive service since they are not temperature sensitive. Y-Check valves generally have lighter shut-off characteristics than ball checks at the same pressures. The valve requires 2.9 PSI differential pressure for tight seal and 0.29 PSI process pressure to fully open.

Dimensions for Type 304

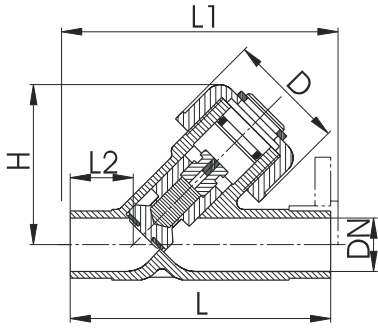

Inch	PSI	Cv-value [$\Delta p=1$ psi] [gal/min]	Lbs	D [inch]	L [inch]	L1 [inch]	L2 [inch]	H [inch]
1/2	150	6.7	0.2	1.69	5.63	5.87	1.46	2.56
3/4	150	11.9	0.25	1.85	6.30	6.54	1.77	2.95
1	150	21.0	0.4	2.20	6.85	7.09	1.85	3.54
1 1/4	150	30.8	0.6	2.52	7.40	7.64	0.24	4.02
1 1/2	150	49.0	1.0	3.23	8.07	8.31	2.13	4.84
2	150	77.0	1.5	3.74	8.86	9.09	2.48	5.67
3	150	168.0	3.5	4.09	12.24	12.64	3.54	8.03

Pressure-Temperature Diagram Type 304

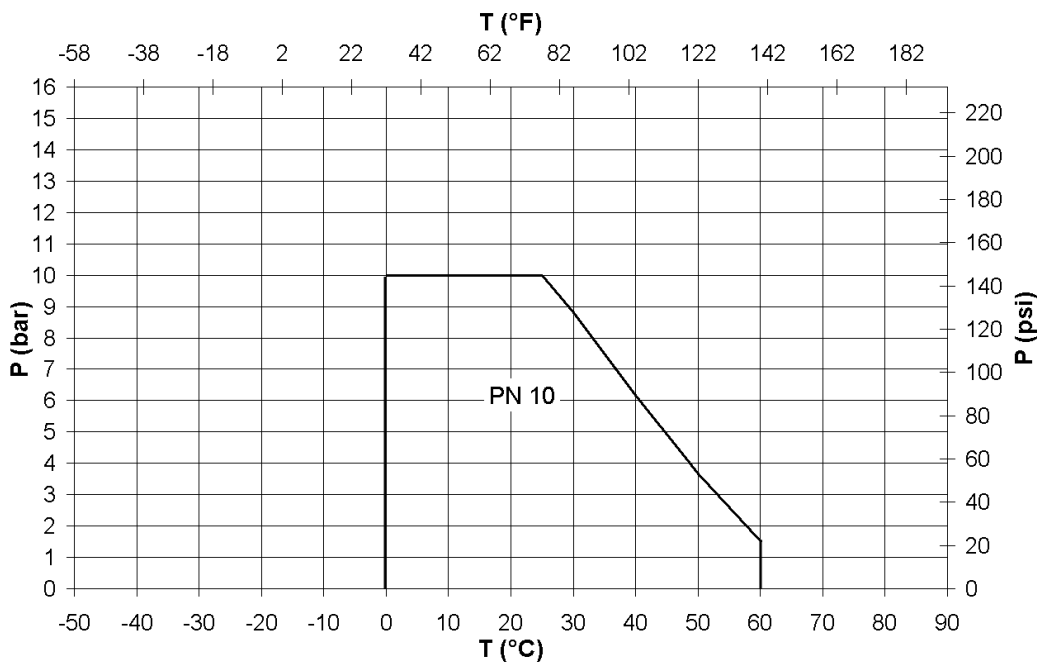

Translucent PVC

Size [inch]	IPS Spigot	
	EPDM	FPM
1/2	192 304 006	192 304 031
3/4	192 304 007	192 304 032
1	192 304 008	192 304 033
1 1/4	192 304 009	192 304 034
1 1/2	192 304 010	192 304 035
2	192 304 011	192 304 036
3	192 304 013	192 304 038