

Section 9

Fuseal 25/50™ Corrosive Waste Piping System



Glossary

S	= Fuseal Electrofusion Socket
SPG	= Spigot End (same dimension as pipe outside diameter)
FT	= Female Thread (Straight)
MT	= Male Thread (Straight)
MPT	= Male Pipe Thread
FPT	= Female Pipe Thread

Product Line	Description	Discount
07	Fusion Accessories	_____
57	PVDF Sch. 40 pipe	_____
58	PVDF Fusion Fittings-Molded	_____
59	PVDF Fusion Fittings-Fab	_____

The technical information given in this publication implies no warranty of any kind and is subject to change without notice. Please consult our Terms and Conditions of Sale.

Not for Use with Compressed Air or Gases

DO NOT TEST with Air or Air over Water

GF Piping Systems DOES NOT RECOMMEND the use of thermoplastic piping products for systems to transport or store compressed air or gases, or the testing of thermoplastic piping systems with compressed air or gases in above or below ground locations. The use of GF Piping products in compressed air or gas systems automatically voids the warranty for such products, and their use against our recommendation is entirely the responsibility and liability of the installer. GF will not accept responsibility for damage or impairment from its products, or other consequential or incidental damages caused by misapplication, incorrect assembly, and/or exposure to harmful substances or conditions.

For more information about any of our product lines, please call (800) 423-2686.



Fuseal 25/50 PVDF Pipe

62



Fuseal 25/50 PVDF Fusion Fittings

63



Fuseal 25/50 PVDF Cleanouts and Floor Drains

69



Fuseal 25/50 PVDF Traps

72



Fuseal 25/50 PVDF Fusion Accessories

74

Fuseal 25/50 PVDF Pipe

A



Schedule 40 PVDF

20' lengths available upon request

Size (inch)	lengths (ft)	Part No.	Lift Qty (ft)	avg. od (inch)	min. wall (inch)
1 1/2	10	* 37C013015	1800	1.900	0.145
2	10	* 37C013020	1050	2.375	0.154
3	10	* 37C013030	580	3.500	0.216
4	10	* 37C013040	510	4.500	0.237
6	10	* 37C013060	220	6.625	0.280

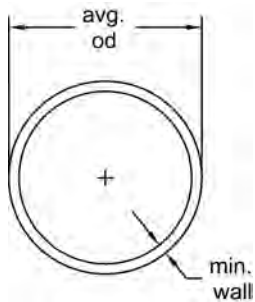

Fuseal 25/50 PVDF Fusion Fittings

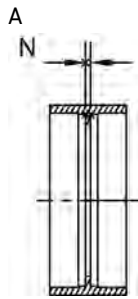

Coupling (S x S)

Size (inch)	Part No.	USD	Pack Qty	N (inch)
1 1/2	588001		8	0.13
2	588002		6	0.13
3	588003		3	0.19
4	588004		2	0.19
6	588006		2	0.19

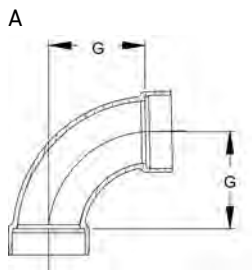

1/4 Bend (91.2°) - Long Sweep (S x S)

Size (inch)	Part No.	USD	Pack Qty	G (inch)
1 1/2	588276		4	2.75
2	588277		4	3.25
3	588278		1	4.06
4	588279		1	4.94
6	*588256F		1	11.00

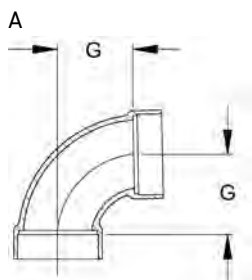

1/4 Bend (91.2°) - Short Sweep (S x S)

Size (inch)	Part No.	D	Pack Qty	G (inch)
1 1/2	589276		4	1.75
2	589277		4	2.31
3	589278		1	3.06
4	589279		1	3.88

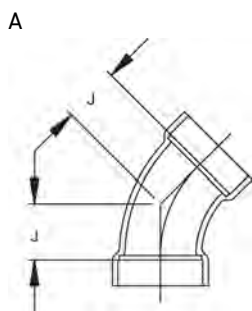

1/8 Bend (45°) (S x S)

Size (inch)	Part No.	Pack Qty	J (inch)
1 1/2	589501	4	1.13
2	589502	4	1.50
3	589503	1	1.75
4	589504	1	2.19
6	*588506F	1	6.25

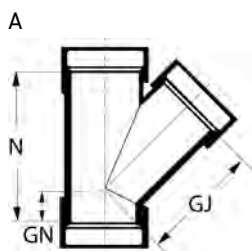

45° Wye (S x S x S)

Size (inch)	Part No.	USD	Pack Qty	GJ (inch)	GN (inch)	N (inch)
1 1/2	585301		4	2.88	1.13	4.00
2	585302		4	3.63	1.38	5.00
3	585303		1	5.00	1.63	6.63
4	585304		1	6.38	1.88	8.25
6	*588306F		1	12.19	6.19	18.38

A

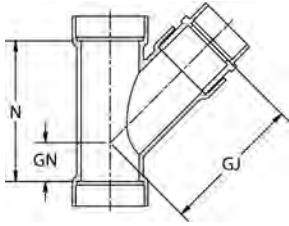
45° Wye - Reducing (S x S x S)

Size (inch)	Part No.	ID	Pack Qty	GJ (inch)	GN (inch)	N (inch)
2 x 2 x 1 1/2	* 588915		4	5.06	1.38	5.00
3 x 3 x 1 1/2	* 588917		1	6.06	0.88	5.00
3 x 3 x 2	588916		1	4.63	0.88	5.00
4 x 4 x 2	588918		1	5.56	0.38	5.06
4 x 4 x 3	588919		1	7.47	1.88	8.25
6 x 6 x 3	* 588330T		1	9.94	1.75	12.38
6 x 6 x 4	* 588331T		1	10.13	2.25	12.38

A

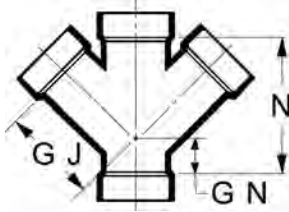
45° Wye - Double (S x S x S x S)

Size (inch)	Part No.	ID	Pack Qty	GJ (inch)	GN (inch)	N (inch)
1 1/2	589380		4	3.50	1.13	4.63
2	589381		4	4.00	1.38	5.38
3	589382		1	5.00	1.63	7.63
4	589383		1	6.38	1.88	9.25
6	* 585396F		1	12.19	6.19	18.38

A

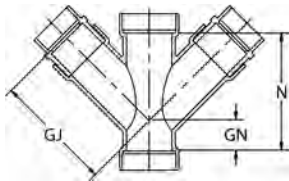
45° Wye - Double Reducing (S x S x S x S)

Size (inch)	Part No.	ID	Pack Qty	GJ (inch)	GN (inch)	N (inch)
2 x 2 x 1 1/2 x 1 1/2	* 585381		2	5.44	1.13	5.38
3 x 3 x 1 1/2 x 1 1/2	* 585382		1	6.50	1.63	7.63
3 x 3 x 2 x 2	* 585383		1	6.50	1.63	7.63
4 x 4 x 2 x 2	* 585384		1	7.50	1.88	9.25
4 x 4 x 3 x 3	* 585385		1	7.47	1.88	8.25
6 x 6 x 3 x 3	* 585387T		1	15.38	6.25	12.38
6 x 6 x 4 x 4	* 585388T		1	15.38	6.25	12.38

A

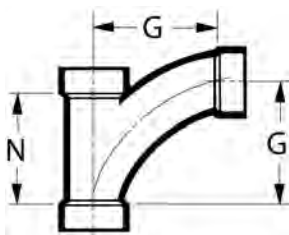
Long Turn Tee Wye (91.2°) (S x S x S)

Size (inch)	Part No.	ID	Pack Qty	G (inch)	N (inch)
1 1/2	584301		4	3.94	3.50
2	584302		4	5.13	4.44
3	584303		1	7.56	6.50
4	584304		1	10.00	8.50

A

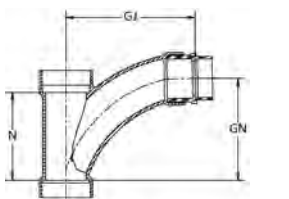
Long Turn Tee Wye (91.2°) - Reducing (S x S x S)

Size (inch)	Part No.	ID	Pack Qty	GJ (inch)	GN (inch)	N (inch)
2 x 2 x 1 1/2	* 584320		2	6.56	5.16	4.44
3 x 3 x 1 1/2	* 584321		1	9.06	7.59	6.50
3 x 3 x 2	* 584322		1	9.06	7.59	6.50
4 x 4 x 2	* 584323		1	10.95	9.84	8.50
4 x 4 x 3	* 584324		1	10.91	9.84	8.50

A

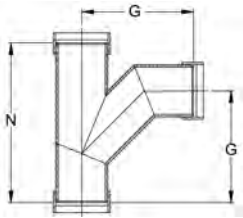

Combo Wye & 1/8 Bend (90°) (S x S x S)

Size (inch)	Part No.	Pack Qty	G (inch)	N (inch)
6	*589306T	1	14.25	20.38

A

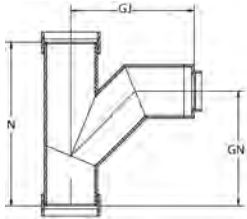

Combo Wye & 1/8 Bend (90°) - Reducing (S x S x S)

Size (inch)	Part No.	USD	Pack Qty	GJ (inch)	GN (inch)	N (inch)
6 x 6 x 3	*589330T		1	9.88	9.88	12.38
6 x 6 x 4	*589331T		1	10.88	10.81	12.38

A

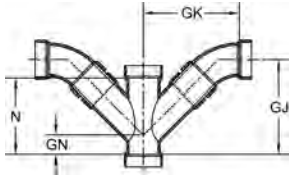

Combo Wye (90°) - Double (S x S x S x S)

Size (inch)	Part No.	Pack Qty	GJ (inch)	GK (inch)	GN (inch)	N (inch)
1 1/2	*587191	1	5.63	5.63	1.13	4.63
2	*587192	1	6.69	6.81	1.38	5.38
3	*587193	1	7.91	8.03	1.63	7.63
4	*587194	1	9.60	10.13	1.88	9.25
6	*587196F	1	19.13	19.19	6.19	18.38

A

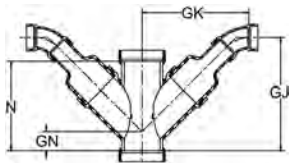

Combo Wye (90°) - Double Reducing (S x S x S x S)

Size (inch)	Part No.	USD	Pack Qty	GJ (inch)	GK (inch)	GN (inch)	N (inch)
2 x 2 x 1 1/2 x 1 1/2	*587181		1	8.36	8.11	1.13	5.38
3 x 3 x 1 1/2 x 1 1/2	*587182		1	9.67	9.15	1.63	7.63
3 x 3 x 2 x 2	*587183		1	9.94	9.81	1.63	7.63
4 x 4 x 2 x 2	*587184		1	11.34	10.96	1.88	9.25
4 x 4 x 3 x 3	*587185		1	11.52	11.38	1.88	9.25
6 x 6 x 3 x 3	*587187T		1	9.88	9.88	1.75	12.38
6 x 6 x 4 x 4	*587188T		1	10.88	10.81	2.25	12.38

A

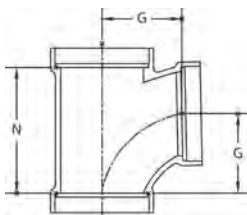

Sanitary Tee (91.2°) (S x S x S)

Size (inch)	Part No.	Pack Qty	G (inch)	N (inch)
1 1/2	589151	4	1.75	2.75
2	589152	4	2.31	3.69
3	589153	1	3.06	4.88
4	589154	1	3.88	6.13

A

Sanitary Tee (91.2°) - Reducing (S x S x S)

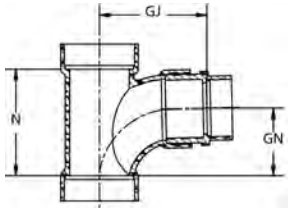

Size (inch)	Part No.	L	Pack Qty	GJ (inch)	GN (inch)	N (inch)
2 x 2 x 1 1/2	*589915		4	3.74	2.34	3.69
3 x 3 x 1 1/2	*589917		1	4.56	3.09	4.88
3 x 3 x 2	*589916		1	4.56	3.09	4.88
4 x 4 x 2	*589918		1	5.00	3.88	6.13
4 x 4 x 3	*589919		1	4.97	3.88	6.13

A

Sanitary Tee (91.2°) - Double (S x S x S x S)

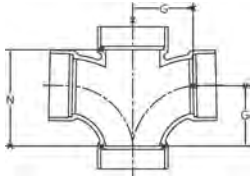

Size (inch)	Part No.	Pack Qty	G (inch)	N (inch)
2	589182	4	2.31	3.69
3	589183	1	3.06	4.88

A

Sanitary Tee (91.2°) - Double Reducing (S x S x S x S)

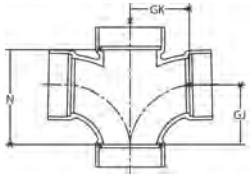

Size (inch)	Part No.	Pack Qty	GJ (inch)	GK (inch)	N (inch)
2 x 2 x 1 1/2 x 1 1/2	*589115	4	2.31	3.75	3.69
3 x 3 x 1 1/2 x 1 1/2	*589117	1	3.06	4.56	4.88
3 x 3 x 2 x 2	*589116	1	3.06	4.56	4.88

A

Pipe Increaser (SPG x SPG)

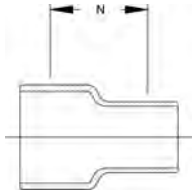

Size (inch)	Part No.	Pack Qty	N (inch)
2 x 1 1/2	588421	6	3.19
3 x 1 1/2	588431	4	3.62
3 x 2	588432	4	3.50
4 x 2	588442	3	4.00
4 x 3	588443	2	3.68

A

Increaser Bushing (SPG x S)

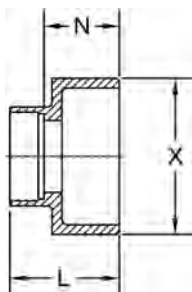

Size (inch)	Part No.	USD	Pack Qty	L (inch)	N (inch)	X (inch)
2 x 1 1/2	588752		6	2.31	1.43	2.38
3 x 1 1/2	588762		4	2.26	1.50	3.50
3 x 2	588754		4	2.38	1.50	3.50
4 x 2	588758		2	2.00	1.13	4.50
4 x 3	588756		2	2.03	1.09	4.50
6 x 4	588446		1	2.19	1.28	6.63

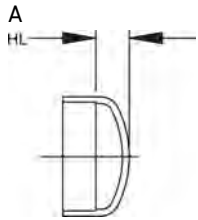

Cap (S)

Size (inch)	Part No.	USD	Pack Qty	HL (inch)
1 1/2	588081		4	0.65
2	588082		4	0.75
3	588083		2	1.62
4	588084		2	2.11
6	588086		1	1.58

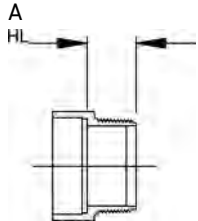

Male Adapter (S x MPT)

Size (inch)	Part No.	USD	Pack Qty	HL (inch)
1 1/2	*589871		4	1.19
2	*589872		4	1.25
3	*589873		2	1.84
4	*589874		2	2.00
6	*589876		1	3.50

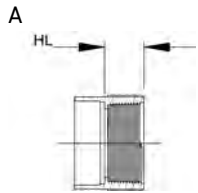

Female Adapter (S x FPT)

Size (inch)	Part No.	USD	Pack Qty	HL (inch)
1 1/2	*589891		4	1.13
2	*589892		4	1.16
3	*589893		2	1.72
4	*589894		2	1.84
6	*589896		1	3.25

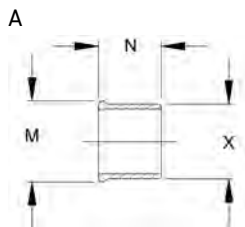

Glass Adapter (SPG x Glass Pipe Bead)

Compression Coupling and Clamp available from Glass Vendor

Size (inch)	Part No.	USD	Pack Qty	M (inch)	N (inch)	X (inch)
1 1/2	*588411		4	2.06	2.00	1.90
2	*588412		4	2.58	2.00	2.38
3	*588413		2	3.69	2.50	3.50
4	*588414		2	4.84	2.50	4.50
6	*588416		1	7.12	3.00	6.63

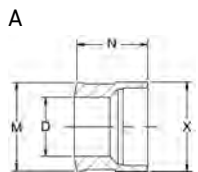

Iron Pipe Adapter (S x Iron Pipe Bead)

Silicon Iron Clamp available from Iron Pipe Vendor

Size (inch)	Part No.	USD	Pack Qty	D (inch)	M (inch)	N (inch)	X (inch)
1 1/2	*589431		4	1.50	2.25	1.88	2.25
2	*589432		4	2.00	2.81	2.00	2.75
3	*589433		2	3.00	3.81	2.63	3.95
4	*589434		2	4.00	4.81	2.63	5.01

A

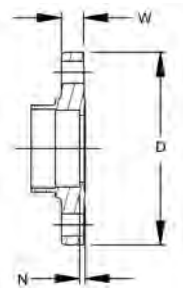

Flange - Solid ANSI 150 lb. Pattern (S)

Size (inch)	Part No.	USD	Pack Qty	# holes	bolt hole dia. (inch)	bolt cir. dia. (inch)	D (inch)	N (inch)	W (inch)
1 1/2	588921		1	4	1	4	5.00	0.16	0.66
2	588922		1	4	1	5	6.00	0.14	0.75
3	588923		1	4	1	6	7.50	0.16	0.94
4	588924		1	8	1	8	9.00	0.16	1.14
6	588926		1	8	1	10	10.94	0.25	1.02

A

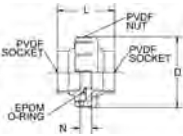

Union (PVDF x PVDF)/PVDF Nut (S x S)

Size (inch)	EPDM Part No.	USD	FKM Part No.	Pack Qty	D (inch)	L (inch)	N (inch)
1 1/2	*588261		*588271	2	3.75	3.38	0.63
2	*588262		*588272	2	4.63	3.75	0.75
3	*588263		*588273	2	6.75	4.68	0.90
4	*588264		*588274	2	8.50	5.54	1.00

A

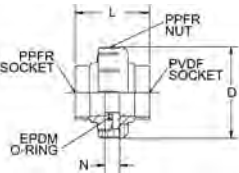

Union (PPFR x PVDF)/PPFR Nut (S x S)

Size (inch)	EPDM Part No.	USD	FKM Part No.	Pack Qty	D (inch)	L (inch)	N (inch)
1 1/2	*588281		*589291	2	3.75	3.38	0.63
2	*588282		*589292	2	4.63	3.75	0.75
3	*588283		*589293	2	6.75	4.68	0.90
4	*588284		*589294	2	8.50	5.54	1.00

A

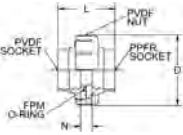

Union (PVDF x PPFR)/PVDF Nut (S x S)

Size (inch)	EPDM Part No.	USD	FKM Part No.	Pack Qty	D (inch)	L (inch)	N (inch)
1 1/2	*589281		*588291	2	3.75	3.38	0.63
2	*589282		*588292	2	4.63	3.68	0.75
3	*589283		*588293	2	6.75	4.75	0.90
4	*589284		*588294	2	8.50	5.54	1.00

Fuseal 25/50 PVDF Cleanouts and Floor Drains

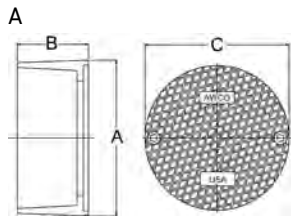

Nickel Bronze Floor Cleanout Housing

Size (inch)	Part No.	USD	A (inch)	B (inch)	C (inch)
All	* 527715A	432.12	6.13	2.81	5.70

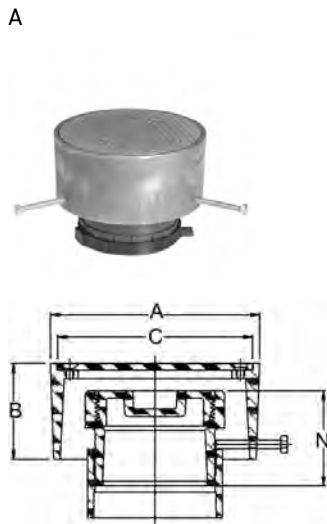

Nickel Bronze Floor Cleanout Assembly (S)

2" adjustment

Size (inch)	Part No.	USD	Pack Qty	A (inch)	B (inch)	C (inch)	N (inch)
3	* 588713A	741.00	1	6.13	2.81	5.70	2.78
4	* 588714A	824.00	1	6.13	2.81	5.70	3.06

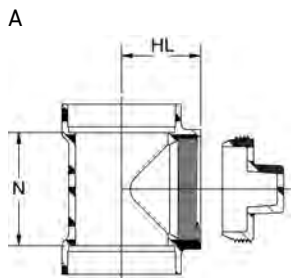

Cleanout Tee with Plug (S x S x FT)

Size (inch)	Part No.	USD	Pack Qty	HL (inch)	N (inch)
1 1/2	588114A	144.00	2	1.82	2.12
2	588115A	156.00	2	2.13	2.74
3	588116A	168.00	2	2.63	3.75
4	588117A	180.00	2	3.38	5.00
6	* 588118AF	360.00	1	7.75	18.00

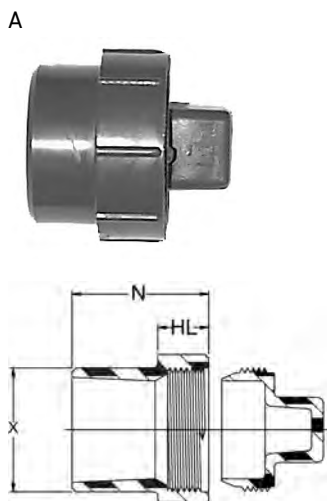

Cleanout Adapter with Plug (Spg x FT)

Size (inch)	Part No.	USD	Pack Qty	HL (inch)	N (inch)	X (inch)
1 1/2	588701	108.00	2	0.78	2.09	1.90
2	588702	120.00	2	0.78	2.22	2.38
3	588703	132.00	2	1.09	2.66	3.50
4	588704	144.00	2	1.13	2.94	4.50
6	588706	288.00	1	1.31	2.63	6.63

A

Countersink Plug for Cleanout (MT)



Size (inch)	Part No.	USD	Pack Qty	L (inch)	Q (inch)
3	* 589063		1	1.03	1.31
4	* 589064		1	1.16	1.63

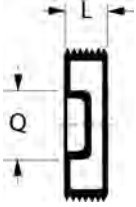

A

Floor Drain (S)



Size (inch)	Part No.	U	Pack Qty	A (inch)	B (inch)	C (inch)	D (inch)	E (inch)	F (inch)
3	589750		1	8.50	12.00	1.63	5.25	3.63	4.31
4	589751		1	8.50	12.00	1.63	5.25	3.63	4.31

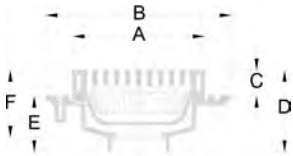

A

Replacement Strainer for Floor Drain



Size (inch)	Part No.
All	* 587502

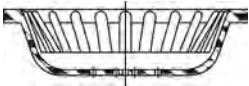

A

Replacement Grate for Floor Drain



Size (inch)	Part No.
All	* 587503

A

Anti-splash Funnel for Floor Drain

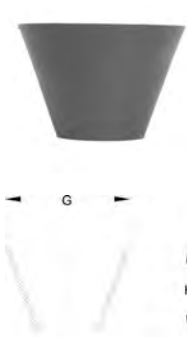

Size (inch)	Part No.	G (inch)	H (inch)
All	* 587777	6	

Fuseal 25/50 PVDF Traps

A

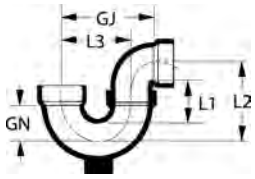

P-Trap with Cleanout (S x S)

1-1/2" - 4" U-Bend Joint must be fused in the field

Size (inch)	Part No.	Pack Qty	GJ (inch)	GN (inch)	L1 (inch)	L2 (inch)	L3 (inch)
1 1/2	* 588201	2	4.71	1.68	2.06	3.64	3.50
2	* 588202	2	6.94	2.44	2.71	4.75	5.06
3	* 588203	2	8.88	2.79	3.41	6.43	6.75
4	* 588204	2	10.75	3.88	3.88	8.06	8.50

A

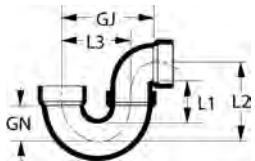

P-Trap (S x S)

6" U-Bend Joint is Factory Fused
1-1/2" - 4" U-Bend Joint must be fused in the field

Size (inch)	Part No.	USD	Pack Qty	GJ (inch)	GN (inch)	L1 (inch)	L2 (inch)	L3 (inch)
1 1/2	588991		2	4.71	1.68	2.06	3.64	3.50
2	588992		2	6.94	2.44	2.71	4.75	5.06
3	588993		2	8.88	2.79	3.41	6.43	6.75
4	588994		2	10.75	3.88	3.88	8.06	8.50
6	* 588996F		1	28.06	11.19	10.81	17.44	16.88

A

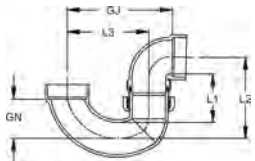

P-Trap with Union Connection (S x S)

Size (inch)	Part No.	USD	Pack Qty	GJ (inch)	GN (inch)	L1 (inch)	L2 (inch)	L3 (inch)
1 1/2	* 588211		2	4.84	1.68	2.38	4.00	3.50
2	* 588212		2	6.50	2.43	2.84	4.88	5.06

A

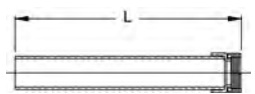

Swivel Sink Strainer Adapter with Gasket (SPG x FT)

Size (inch)	Part No.	Pack Qty	L (inch)	N (inch)
1 1/2	* 589217	5	13.00	0.44

A



Replacement Gasket for Swivel Sink Strainer

Material: FKM

Size (inch)	Part No.	USD	Pack Qty
1 1/2	* 37X002100		5

A

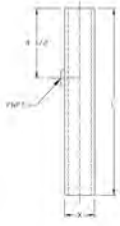

Trap Primer w/FPT Tap (SPG x SPG)

Size (inch)	Part No.	L (inch)	X (inch)	FPT (inch)
1 1/2	* 587201	12	1.90	1/2
2	* 587202	12	2.38	1/2
3	* 587203	12	3.50	1/2
4	* 587204	12	4.50	1/2
6	* 587206	12	6.63	3/4

Fuseal 25/50 PVDF Fusion Accessories

B

Loose Coil



Size (inch)	Part No.	USD	Pack Qty
1 ½	* 37C160801		10
2	* 37C160802		10
3	* 37C160803		10
4	* 37C160804		10
6	* 37C160806		10

B

Metal Clamp



Size (inch)	Part No.	USD weight (lb)	Pack Qty
1 ½	* 37Z000150	0.130	10
2	* 37Z000200	0.161	10
3	* 37Z000300	0.340	10
4	* 37Z000400	0.399	1
6	* 37Z000600	0.399	1

GF Piping Systems

Corrosive Waste Piping System
Specification Submittal Data Sheet
Fuseal 25/50™ PVDF Pipe and Fittings

Pipe

Pipe will be manufactured to the dimensions and tolerances of ASTM F1673. The polyvinylidene fluoride (PVDF) material conforms to ASTM D3222 and will also have a flame spread of less than 25 and smoke developed index of less than 50 when tested in accordance to ASTM E84, UL723 and NFPA 255. The pipe will conform to UPC®, the City of Los Angeles and the Commonwealth of Massachusetts standards.

- PVDF Sch.40 Pipe - 10 ft. Lengths

Fittings

Molded and fabricated fittings will be manufactured to the dimensions and tolerances of ASTM F1673. Molded fitting patterns will conform to ASTM D3311. The polyvinylidene fluoride (PVDF) material will conform to ASTM D3222 and will also have a flame spread of less than 25 and smoke developed index of less than 50 when tested in accordance to ASTM E84, UL723 and NFPA 255. The molded fittings will conform to UPC®, the fabricated fittings to IAPMO, all fittings to the City of Los Angeles and the Commonwealth of Massachusetts standards.

- PVDF Sch.40 Molded
- PVDF Sch.40 Fabricated

Joining

Pipe and fittings are joined by electrofusion joints and consist of a PVDF jacked wire with duplex plug connection.

- Electrofusion

Job Name: _____

Job Location: _____

Engineer: _____

Contractor: _____

Representative: _____

GF Piping Systems

Corrosive Waste Piping System

Specification Submittal Data Sheet

Fuseal 25/50™ PVDF Nickel Bronze Floor Cleanout

Floor Cleanout

Corrosion resistant finished floor cleanout is manufactured from polyvinylidene fluoride conforming to ASTM D3222 and will also have a flame spread of less than 25 and smoke developed index of less than 50 when tested in accordance to ASTM E84, UL723 and NFPA 255. The fitting will conform to UPC®, the City of Los Angeles and the Commonwealth of Massachusetts standards. The assembly includes a molded cleanout, countersunk plug, an adjustable access housing and removable cover. The housing has approximately 2" of adjustment. The access housing and cover are cast from 12% nickel bronze. AWCO (Acid Waste Cleanout) and USA are cast on the top cover.

- Nickel Bronze Housing and Cover
- 3" PVDF Sch.40 Molded with Nickel Bronze Housing and Cover
- 4" PVDF Sch.40 Molded with Nickel Bronze Housing and Cover

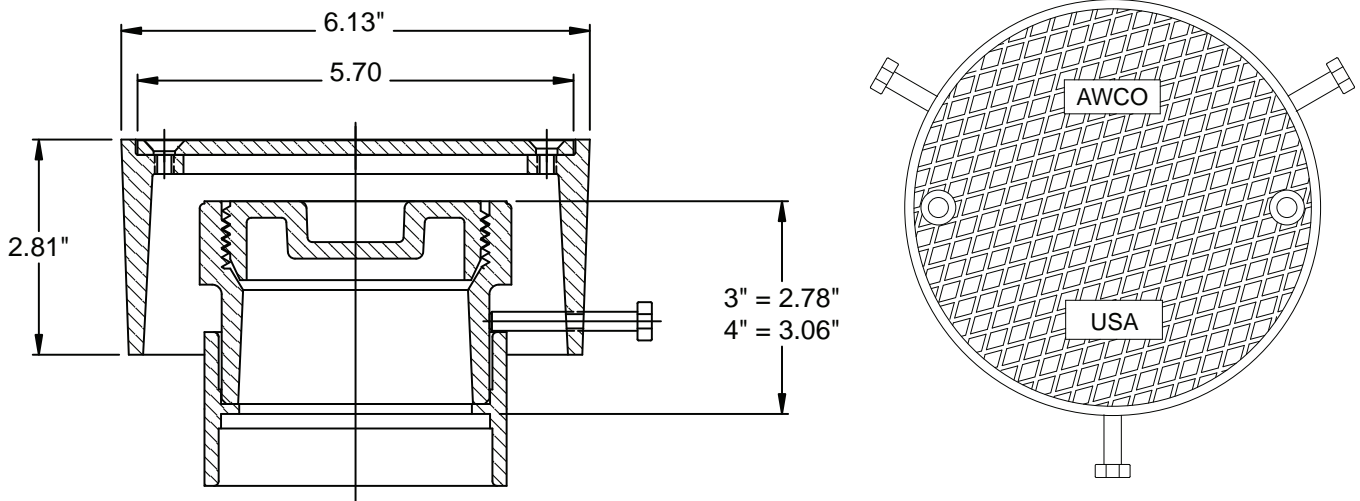

Job Name: _____

Job Location: _____

Engineer: _____

Contractor: _____

Representative: _____

UPC is a registered trademark of the International Association of Plumbing and Mechanical Officials

GF Piping Systems

Corrosive Waste Piping System
 Specification Submittal Data Sheet
 Fuseal 25/50™ PVDF Floor Drain

Floor Drain

Fixed height, moderate traffic floor drain with 8" diameter grate, sediment strainer and removable flashing collar that is manufactured from polyvinylidene fluoride (PVDF) conforming to ASTM D3222 and will also have a flame spread of less than 25 and smoke developed index of less than 50 when tested in accordance to ASTM E84, UL723 and NFPA 255. The floor drain will conform to UPC®, the City of Los Angeles and the Commonwealth of Massachusetts standards. The maximum flow rate is 44 GPM at 2" water level. The average failure load for the grate is 3,300 lbs with a maximum live load of 825 lbs. A boss is provided on the body of the drain which can be drilled and tapped to accept a primer line up to 1/2" NPT.

- 3" PVDF Sch.40 Molded Floor Drain
- 4" PVDF Sch.40 Molded Floor Drain
- Anti-Splash Funnel

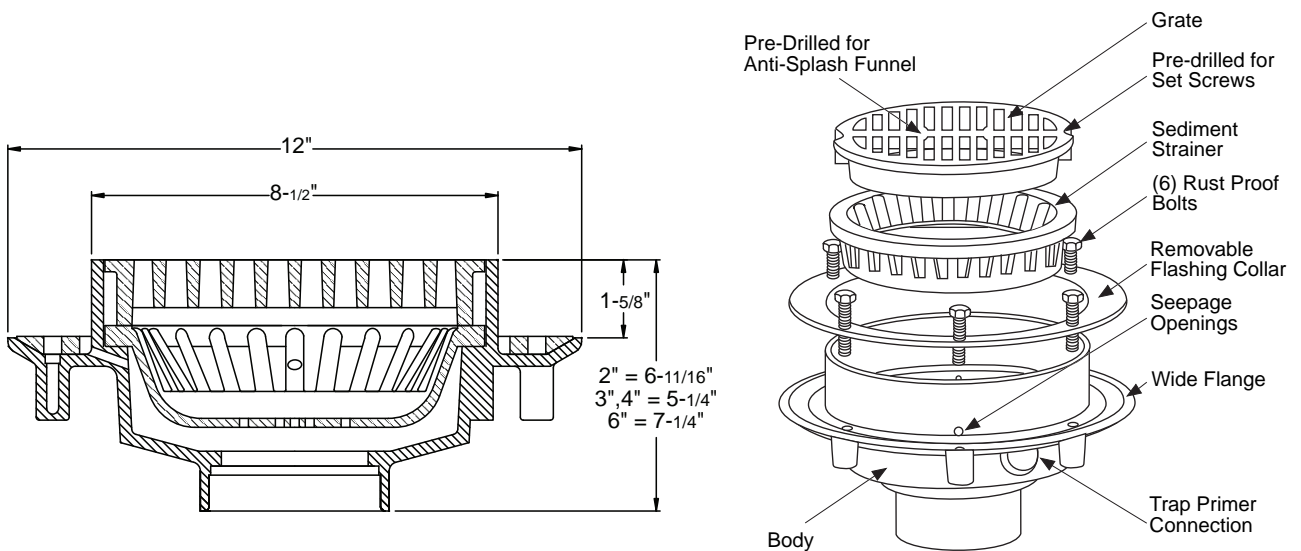

Job Name: _____

Job Location: _____

Engineer: _____

Contractor: _____

Representative: _____